

1 船舶艉轴密封装置

CWM 系列抗冲击型 船舶艉轴端面密封装置

CWM Series Anti-shock Stern Shaft Seal

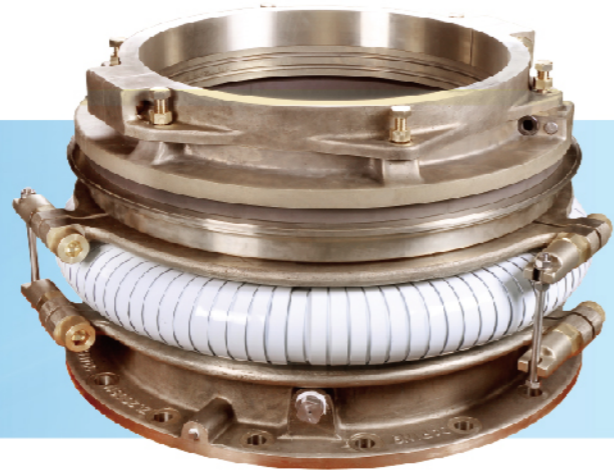

产品特点 Product Features

- Ω型弹性补偿机构，轴向、径向大位移自动补偿。
 - 受大冲击干扰时不易损坏或卡轴，并迅速恢复密封状态。
 - 剖分式结构，动、静密封摩擦副耐磨损且易更换维修。
 - 耐海水腐蚀，寿命长，维护成本低，无需附加润滑系统。
 - 适用于各类舰船轴系艉舱室水密封。
- Automatic compensation of both axial and radial displacement due to Ω-type elastic compensation structure.
 - Uneasy to be damaged or jammed under high impact environment.
 - Dynamic & Static friction pairs, easy maintenance due to split structure.
 - Anti-corrosion, easy maintenance, good environmental adaptability, long life span.
 - Applied for marine ship stern shaft seals.

主要参数 Main Specifications

- 适用轴径：Φ100~Φ1000mm
 - 适用转速：0~800rpm (随轴径配定)
 - 适用水压：0~0.2MPa
 - 水泄漏量：≤Φd×1.5/100(L/h)
- Shaft Diameter：Φ100~Φ1000mm
 - Rotating Speed：0~800rpm (depend on the shaft diameter)
 - Water Pressure：0~0.2MPa
 - Water Leakage：≤Φd×1.5/100(L/h)

选型原则 Model Selection Principle

- 根据安装艉轴密封装置处轴径（或轴套外径）和接口尺寸要求选择相应型号规格。
 - 该系列产品需预留足够的维修操作空间。
 - 轴径、接口等可根据用户要求进行设计。
- Selecting according to the installation of stern shaft sealing device diameter of shaft (or collar diameter) and interface size requirements.
 - Setting aside enough maintenance operation space.
 - Customized design can be done (shaft diameter, connecting interface, etc)

适用标准 Applicable Standard

GJB4000-2000 GJB150.18-1986

尺寸及参数 Dimensions & Parameters

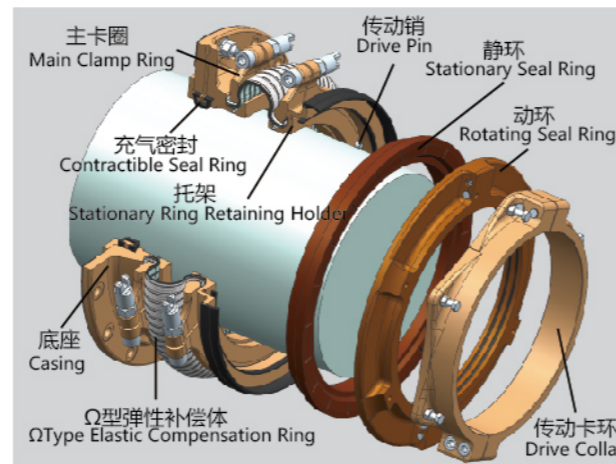
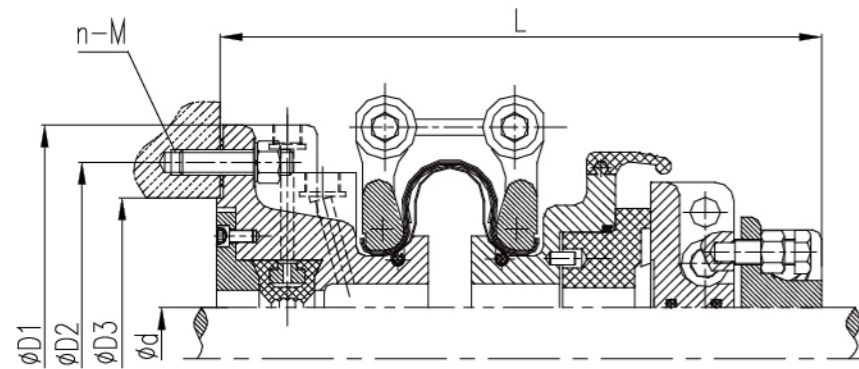

型号 Model	尺寸参数 Dimensions (mm)					技术指标 Technical Specifications		
	d	D1	D2	D3	L(预压缩前) Pre-compression	n-M	动态位移补偿量 (压缩方向为+) Dynamic Displacement Compensation (mm)	水泄漏量 Water Leakage (L/h)
CWM120	120	340	310	280	≈330	8-M12	-2~+12	≤1.8
CWM130	130							≤2
CWM145	145							≤2.2
CWM150	150							≤2.3
CWM160	160	420	370	330	≈374	≤2.4		
CWM180	180					≤2.7		
CWM200	200					≤3		
CWM215	215					≤3.2		
CWM230	230	460	413	374	≈380	≤3.5		
CWM235	235					≤3.5		
CWM240	240					≤3.6		
CWM250	250					≤3.8		
CWM260	260	500	450	410	≈410	≤3.9		
CWM270	270					≤4.1		
CWM280	280					≤4.2		
CWM290	290					≤4.4		
CWM300	300	540	490	450	≈425	≤4.5		
CWM310	310					≤4.7		
CWM320	320					≤4.8		
CWM330	330					≤5		
CWM340	340	570	520	480	≈425	≤5.1		
CWM350	350					≤5.3		
CWM360	360					≤5.4		
CWM370	370					≤5.6		
CWM380	380	620	570	530	≈450	≤5.7		
CWM390	390					≤5.9		
CWM400	400					≤6		
CWM440	440					≤6.6		
CWM450	450	710	660	610	≈500	≤6.8		
CWM520	520					≤7.8		
CWM530	530					≤8		
CWM600	600					≤9		
CWM670	670	920	870	820	≈550	≤6.7		
CWM710	710					≤10.7		
CWM750	750					≤11.3		
CWM760	760					≤11.4		

注：表列参数为标准设计供参考，可按用户实际需求进行设计制造。
Customized design can be done.